



**MAURER**  
SCHOOL OF LAW

**LOWELL E. BAIER HALL  
GROUND FLOOR**

**211 S. INDIANA AVE.  
BLOOMINGTON, IN 47405**

**T  
H  
I  
R  
D  
S  
T  
R  
E  
E  
T**

**JEROME HALL LAW LIBRARY**

**001**

**NORTHEAST  
ENTRANCE**

**NORTHWEST -  
ADA ENTRANCE**

**INDIANA AVENUE**

**INDIANA AVENUE**

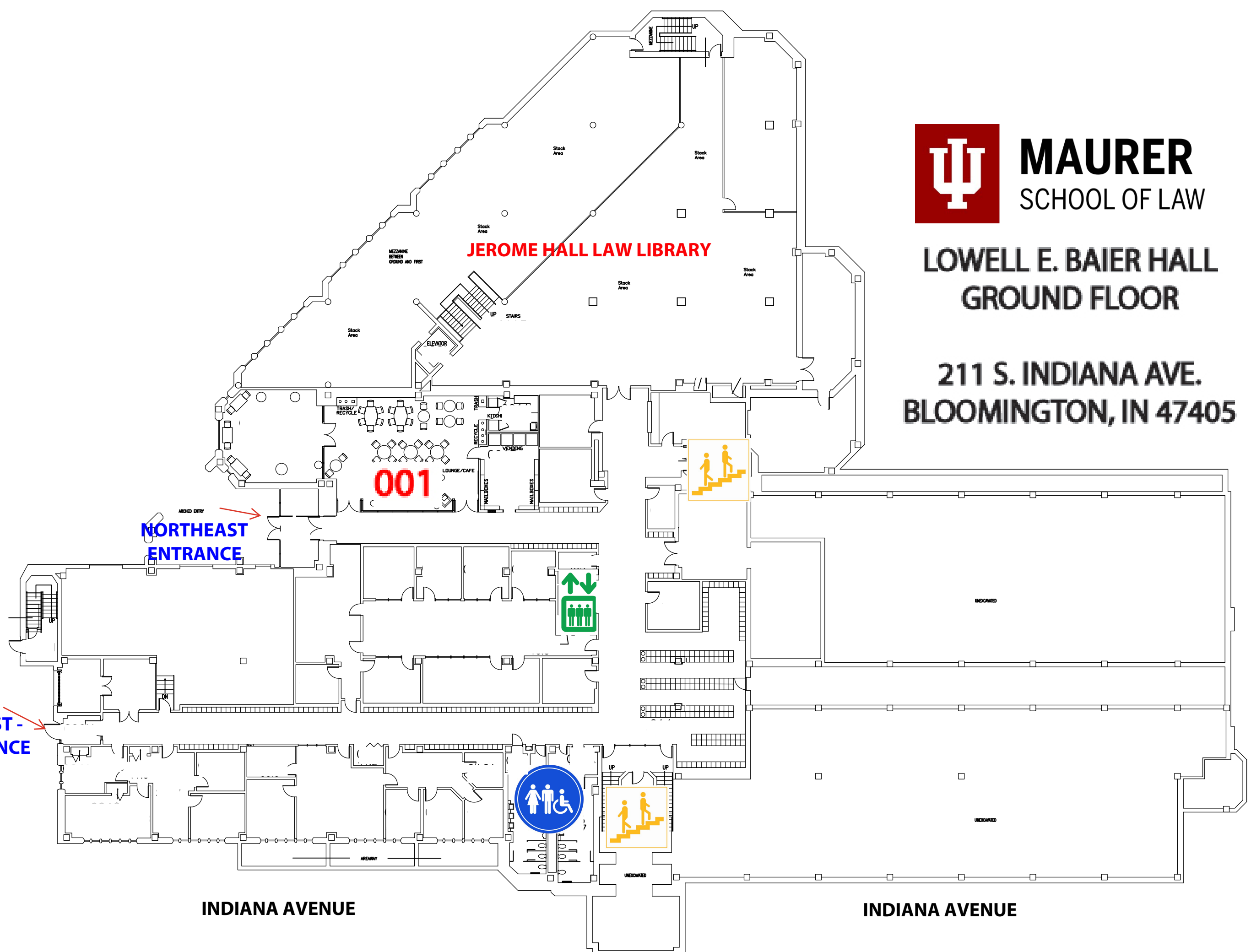



**MAURER**  
SCHOOL OF LAW

**LOWELL E. BAIER HALL**  
**FIRST FLOOR**

**211 S. INDIANA AVE.**  
**BLOOMINGTON, IN 47405**

**T  
H  
I  
R  
D  
S  
T  
R  
E  
E  
T**

**JEROME HALL LAW**  
**LIBRARY READING**  
**ROOM**

**LAW LIBRARY**  
**LOBBY**

**SESSIONS MOVED**  
**TO 001 ON**  
**GROUND FLOOR**

**DELANEY MOOT**  
**COURT ROOM (123)**

**MAIN ENTRANCE ON INDIANA AVENUE**

**SOUTHWEST**  
**ENTRANCE**

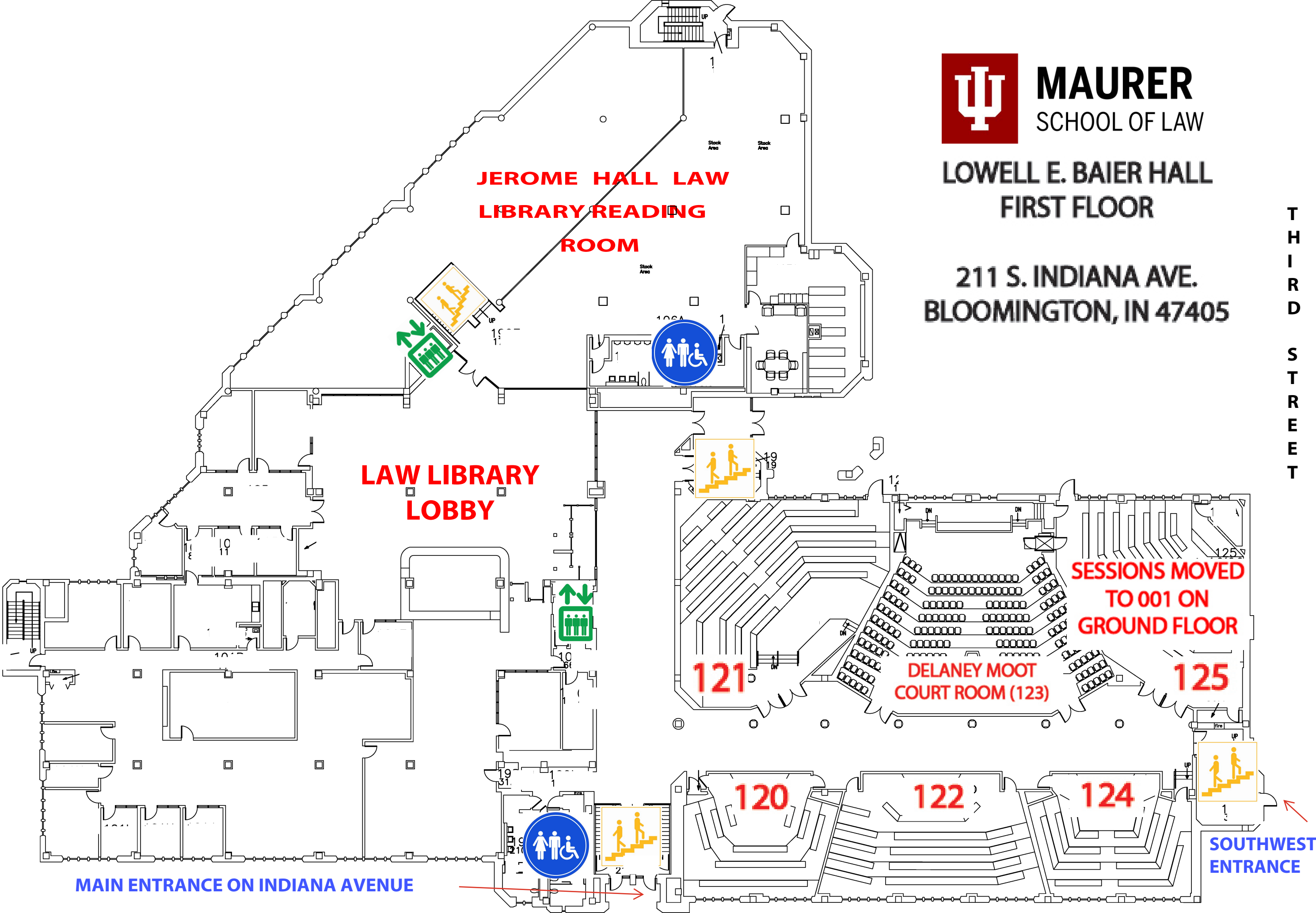



**MAURER**  
SCHOOL OF LAW

**LOWELL E. BAIER HALL  
SECOND FLOOR**

**211 S. INDIANA AVE.  
BLOOMINGTON, IN 47405**

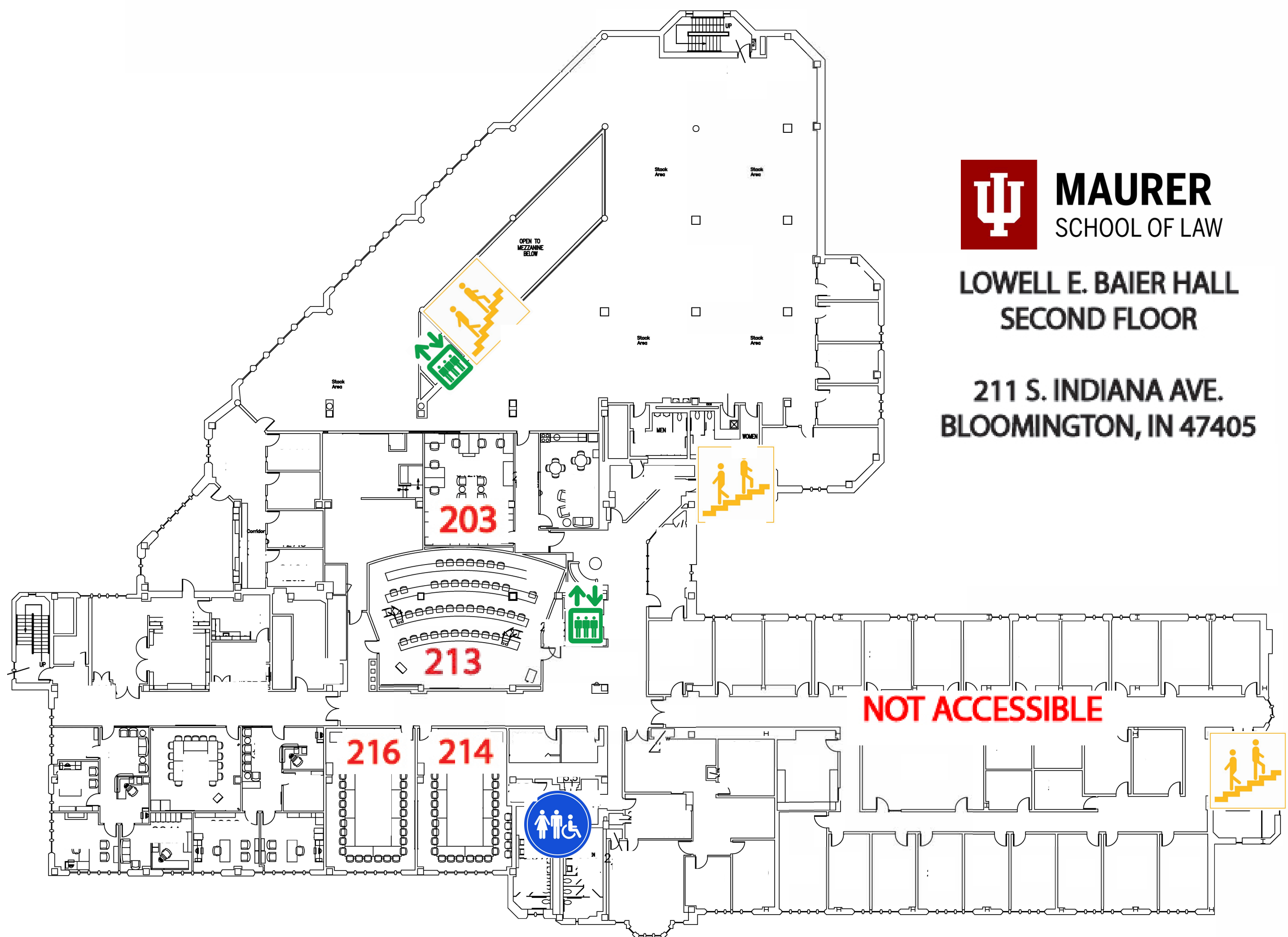



**MAURER**  
SCHOOL OF LAW

**LOWELL E. BAIER HALL  
THIRD FLOOR**

**211 S. INDIANA AVE.  
BLOOMINGTON, IN 47405**

